

# HP Apollo a6000 Chassis

## Quick Setup Instructions



## Site requirements

Select an installation site that meets the detailed installation site requirements described in the setup and installation guide and the site planning guide on the HP website ([http://www.hp.com/go/Apollo\\_6000/docs](http://www.hp.com/go/Apollo_6000/docs)).

## Verifying the pallet contents for the chassis

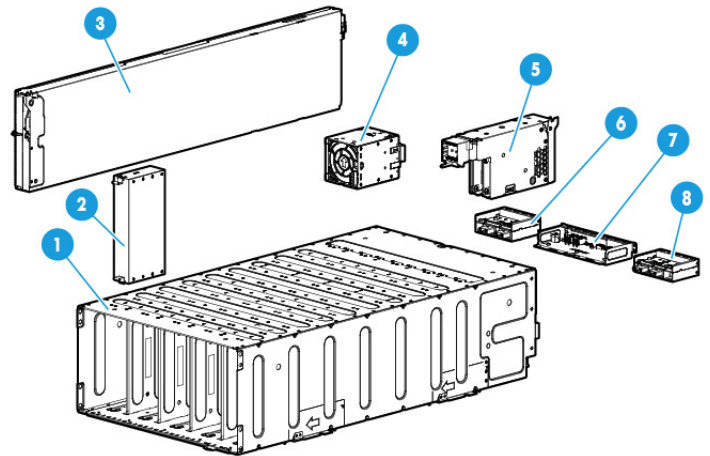

Item	Description
1	HP Apollo a6000 Chassis
2	Server tray blank
3	Server tray*
4	Fan assembly (5)
5	I/O module
6	Power cage (Right)
7	Management module
8	Power cage (Left)
9	HP Apollo a6000 Chassis 5U Rail kit**

\* The quantity depends on the configuration ordered.

\*\* Not shown

© Copyright 2014 Hewlett-Packard Development Company, L.P.

The information contained herein is subject to change without notice. The only warranties for HP products and services are set forth in the express warranty statements accompanying such products and services. Nothing herein should be construed as constituting an additional warranty. HP shall not be liable for technical or editorial errors or omissions contained herein.

Part Number: 755708-001  
May 2014  
Edition: 1



755708-001

# Verifying the pallet contents for the power shelf

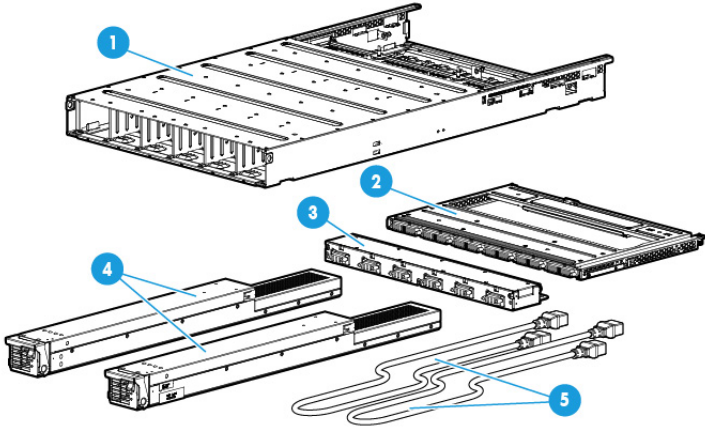

Item	Description
1	Power shelf chassis
2	Power management module
3	AC input module
4	Power supplies*
5	Power cables*
6	HP XL Power Shelf Rack Rail Installation Instructions**

\* The quantity depends on the configuration ordered.  
 \*\* Not shown

## Setting up the chassis

1. Select the proper location for the chassis to be set up, based on requirements detailed in the *HP Apollo a6000 Chassis Setup and Installation Guide* on the HP website ([http://www.hp.com/go/Apollo\\_6000/docs](http://www.hp.com/go/Apollo_6000/docs)).
2. Remove the packing materials from the pallet.
3. Place the chassis in the location selected in step 1.

## Chassis component identification

Before installing front or rear components into the chassis, review chassis slot numbering for each component.

### Server tray bay numbering



### Rear panel components

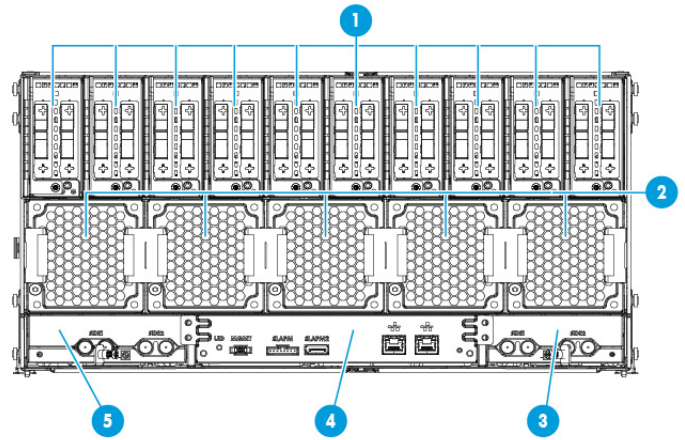

Item	Description
1	I/O modules (10)
2	Fan assemblies (5)
3	Power cage (Right)
4	Management module
5	Power cage (Left)

### Fan assembly bay numbering

The chassis has five fan assemblies located in the rear of the chassis. The following figure identifies the fan assemblies by device number.

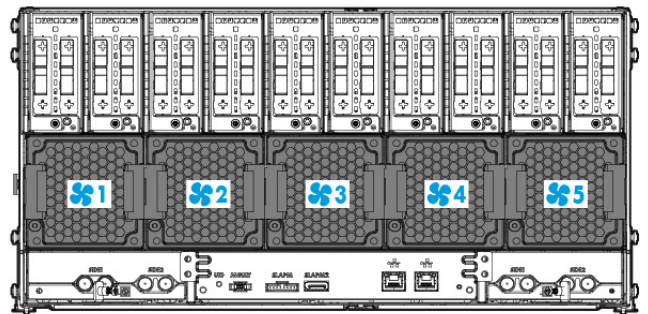

### I/O module bay numbering

The chassis has ten I/O module bays located in the rear of the chassis.

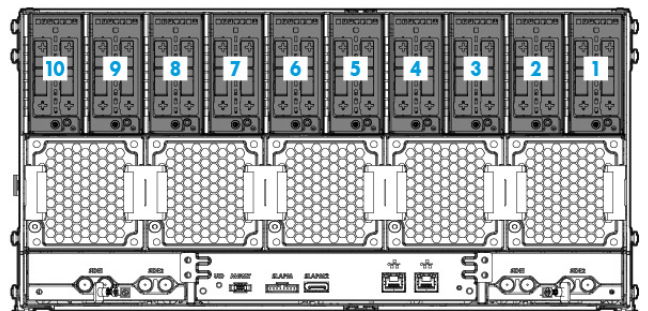

# Installing the chassis into a rack

To install the chassis into a rack, see the *HP Apollo a6000 Chassis Setup and Installation Guide* on the HP website ([http://www.hp.com/go/Apollo\\_6000/docs](http://www.hp.com/go/Apollo_6000/docs)). For more information, see the instructions included with the rail kit.

## Configuration guidelines

To meet thermal requirements, always do the following:

- Populate empty bays with a blank.
- Populate all five fan bays with a fan.

## Installing the front components

**CAUTION:** To prevent improper cooling and thermal damage, do not operate the server tray or the enclosure unless all drive and device bays are populated with either a component or a blank.

Install all server trays into each chassis.

## Installing a server tray blank

**CAUTION:** To prevent improper cooling and thermal damage, do not operate the chassis unless all bays are populated with a component or a blank.

Install the component as indicated.

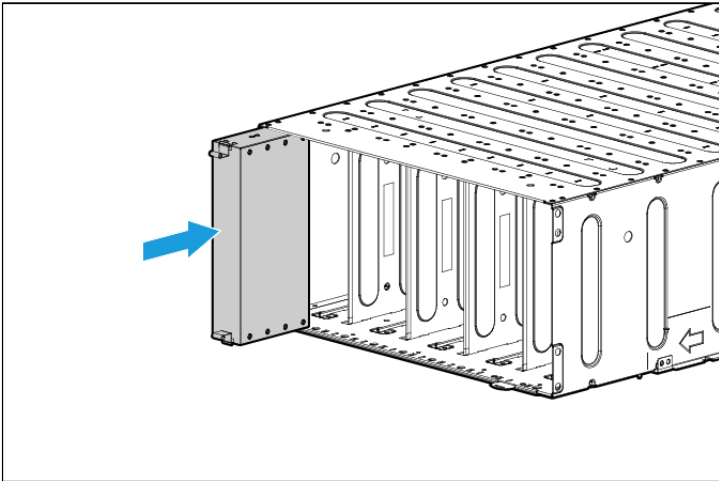

## Installing a server tray

1. Prepare the server tray for installation.

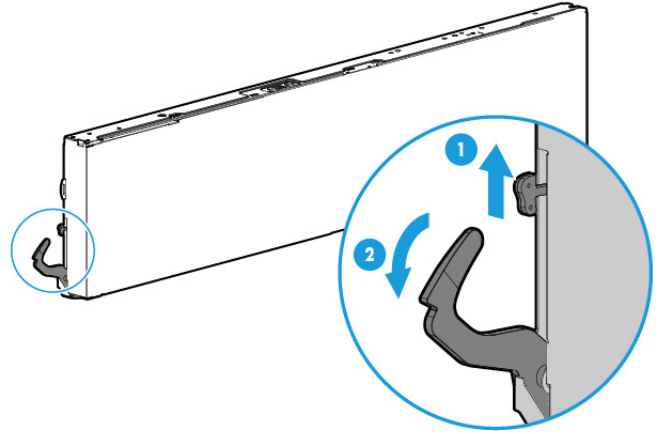

2. Install the server tray. When seated properly, the server tray will be flush with the front of the chassis and the release lever will close completely without resistance.

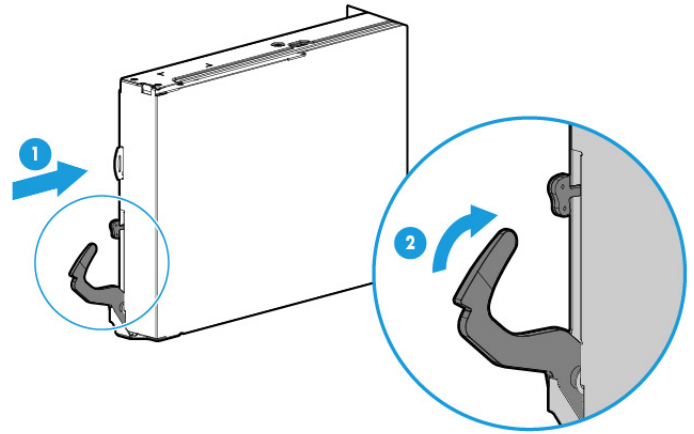

## Installing the rear components

**CAUTION:** To prevent improper cooling and thermal damage, do not operate the enclosure unless all bays are populated with a component or a blank.

## Installing an I/O module

Install the component as indicated.

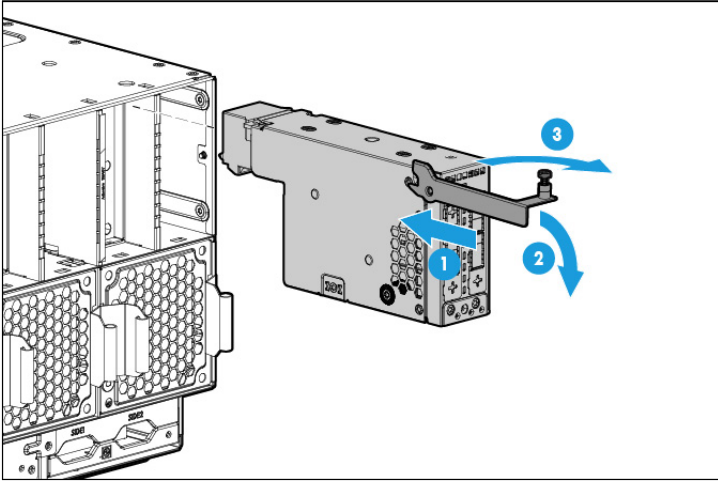

## Installing a system fan

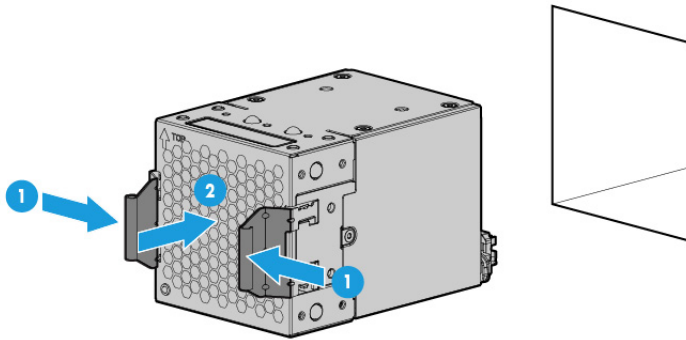

## Installing a power cage

**CAUTION:** To prevent damage to the component, power down the chassis and disconnect all power cords before removing or installing the component.

To install the component:

1. Remove the power cage cover.

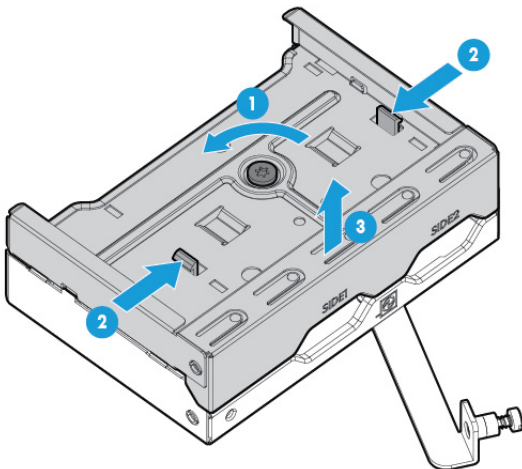

2. Install the power cables in the power cage.

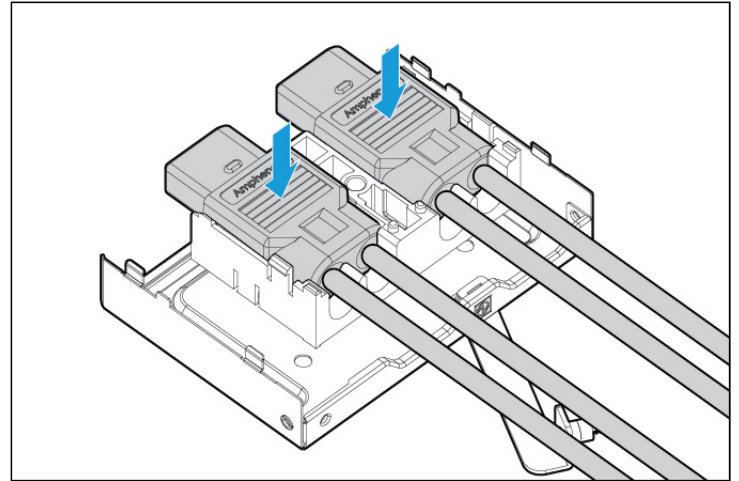

3. Install the power cage cover.

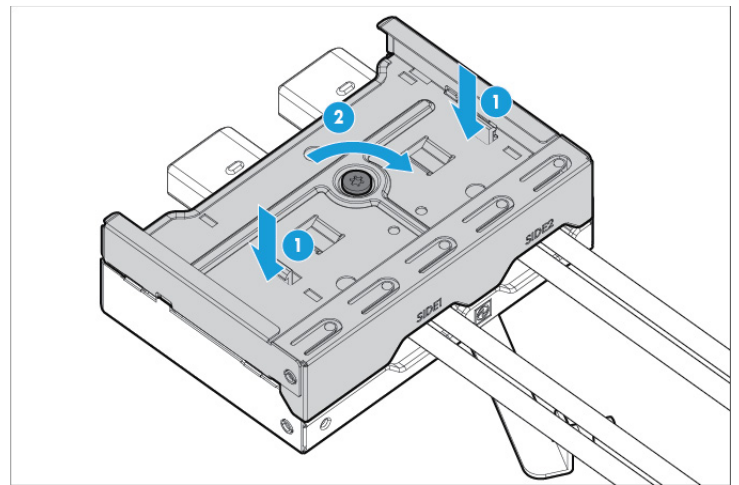

4. Install the power cage.
  - a. Insert the power cage into the correct power cage bay.
  - b. Close the release lever.
  - c. Tighten the screw to secure the power cage to the chassis.

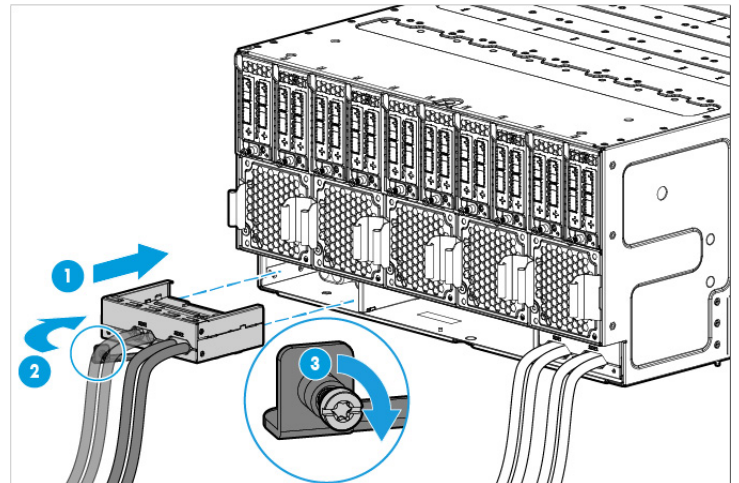

## Installing the management module

**IMPORTANT:** Always complete the installation of both power cages before installing the management module.



Install the component as indicated.

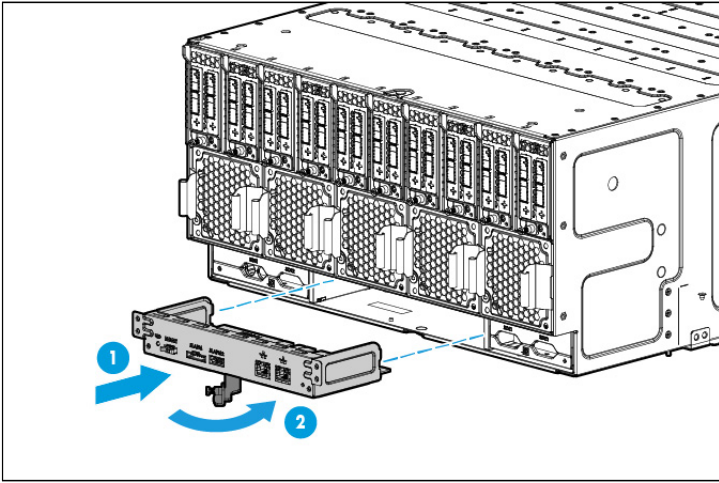

## Installing the power shelf

**CAUTION:** To prevent damage to the component, power down the chassis and disconnect all power cords before removing or installing the component.

To install the component:

1. Install the power shelf rack rails into the rack. For more information, see the *HP XL Power Shelf Rack Rail Installation Instructions*.
2. Install the power shelf.

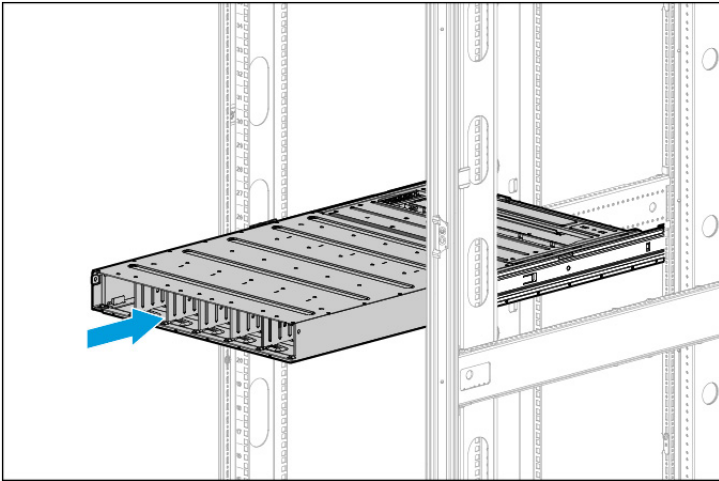

3. Secure the power shelf to the rack.

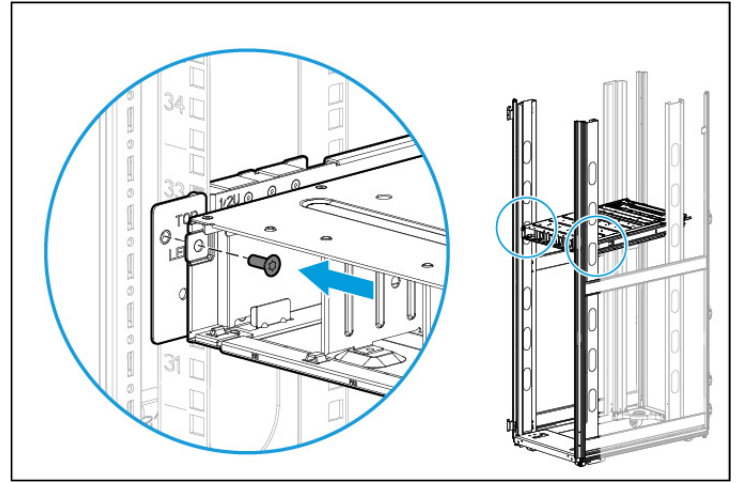

4. Install the power supplies into the power shelf, if needed.

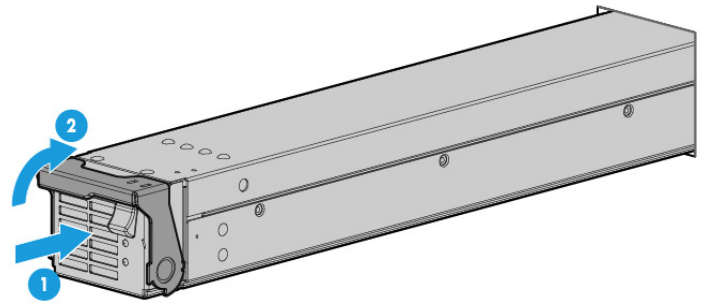

**NOTE:** If additional clearance is required to install power cables, loosen the thumb screw on either side of the shelf and slide the shelf out while installing the cables. Use caution to avoid bending the shelf.

5. Remove the power supply vent cover.
6. Install the 12V DC power cables.
  - a. Insert the cable through the wide opening on either end of the power shelf, and then connect it to the appropriate connector.

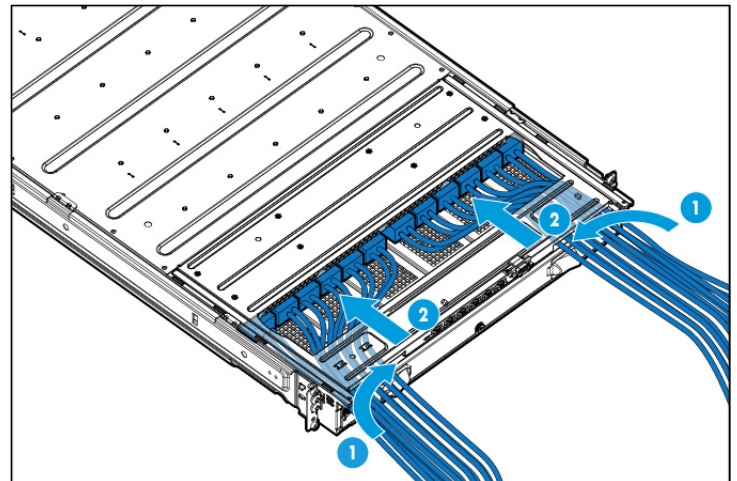

- b. Slide the cables toward the center, allowing them to straighten and hang from the rear of the power shelf.

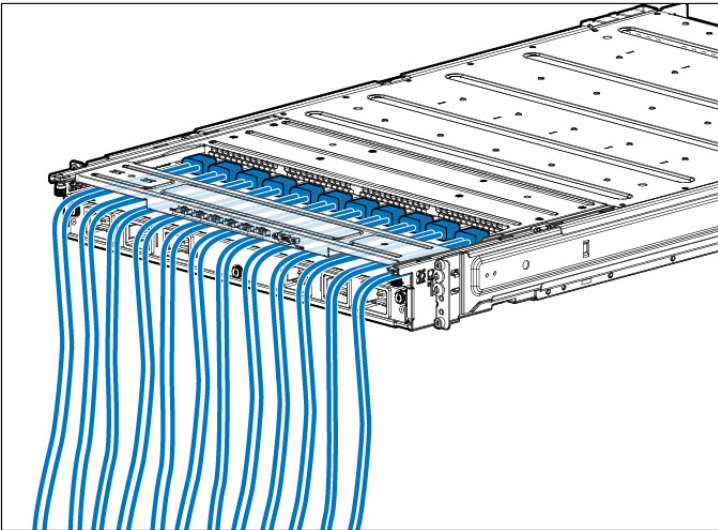

7. Install the cable guard.

**NOTE:** Cables are removed for clarity.

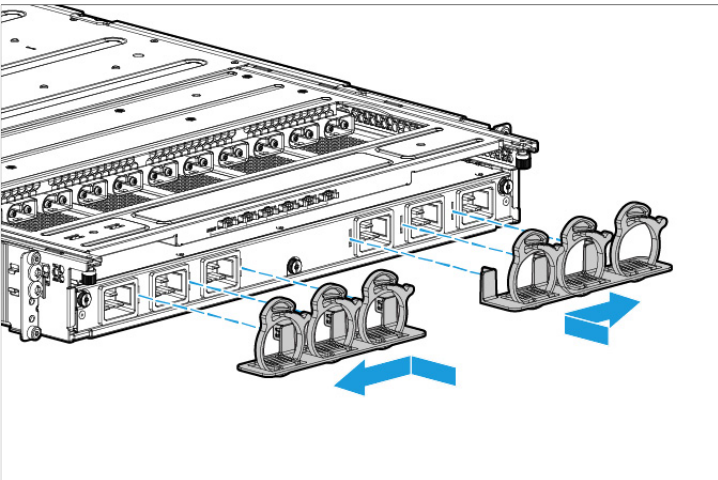

8. Install the power supply vent cover to protect the power supply vents.

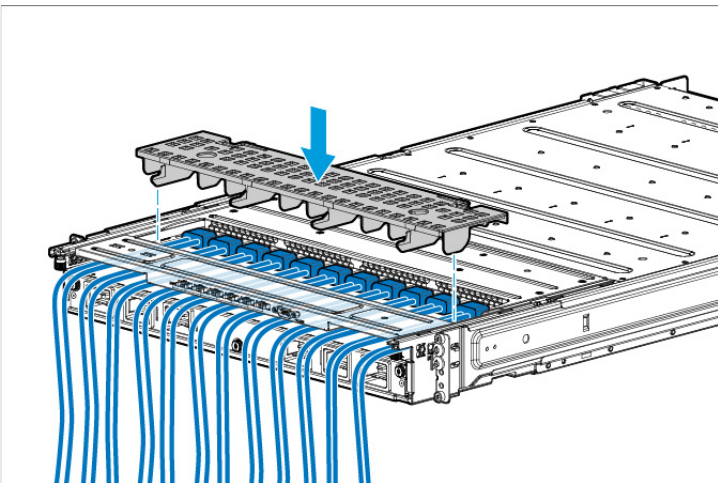

## Connecting the chassis to the power shelf

1. Connect the chassis power cage to the power shelf (blue cables).
2. Connect the chassis management module to the power shelf (green cables).

**NOTE:** The cable configuration might appear different, depending on the configuration of components. For more information about cabling, see the *HP Apollo a6000 Chassis Setup and Installation Guide*.

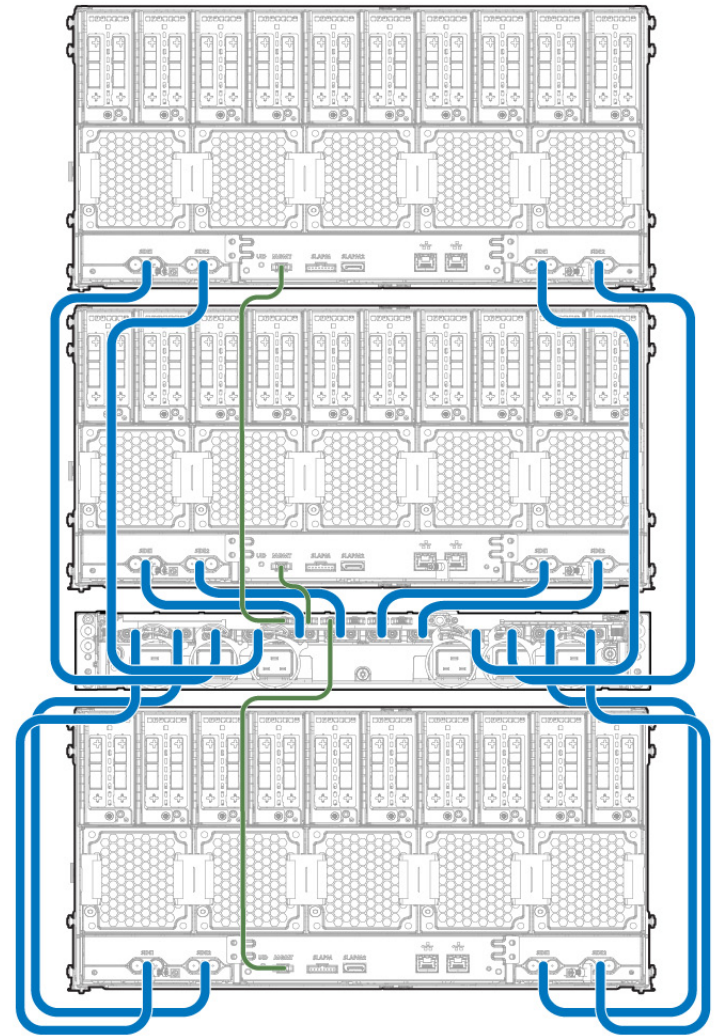

Cable length is determined by the configuration of components.

## Connecting power cables and applying power to the chassis

1. Connect the DC power cable to the power shelf.
2. Connect the AC power cables to the power source (UPS or wall outlet) or to an installed PDU.

## Configuring the chassis

For more information on setting up and configuring your system, see the *HP Apollo a6000 Chassis Setup and Installation Guide*.

# Troubleshooting resources

The *HP ProLiant Gen8 Troubleshooting Guide, Volume I: Troubleshooting* provides procedures for resolving common problems and comprehensive courses of action for fault isolation and identification, issue resolution, and software maintenance on ProLiant servers and server blades. The *HP ProLiant Gen8 Troubleshooting Guide, Volume II: Error Messages* provides a list of error messages and information to assist with interpreting and resolving error messages on ProLiant servers and server blades. The documents are on the HP website (<http://www.hp.com/go/proliantgen8/docs>).

The installation is complete.

## For more information

For more detailed setup and configuration information, see the *HP Apollo a6000 Chassis Setup and Installation Guide*.

For safety information and regulatory notices, see the relevant section of the server tray user guide on the HP website ([http://www.hp.com/go/Apollo\\_6000/docs](http://www.hp.com/go/Apollo_6000/docs)), as well as the *Safety, Compliance, and Warranty Information* document included with your product.

## Documentation feedback

HP is committed to providing documentation that meets your needs. To help us improve the documentation, send any errors, suggestions, or comments to Documentation Feedback (<mailto:docsfeedback@hp.com>). Include the document title and part number, version number, or the URL when submitting your feedback.